

For Pledges:

Please Invoice Me Charge My Credit Card

Monthly

Quarterly

Annually

Method Of Payment:

Check

(made payable to Friends of Turner-Dodge House)

Visa MasterCard

American Express Discover

Card Number: _____

Expiration: _____

Cardholder's Name: _____

Signature: _____

My Brick Should Read:

*Only 14 characters per line
(including punctuation and spaces);
Two-Lines Recommended—Three Available*

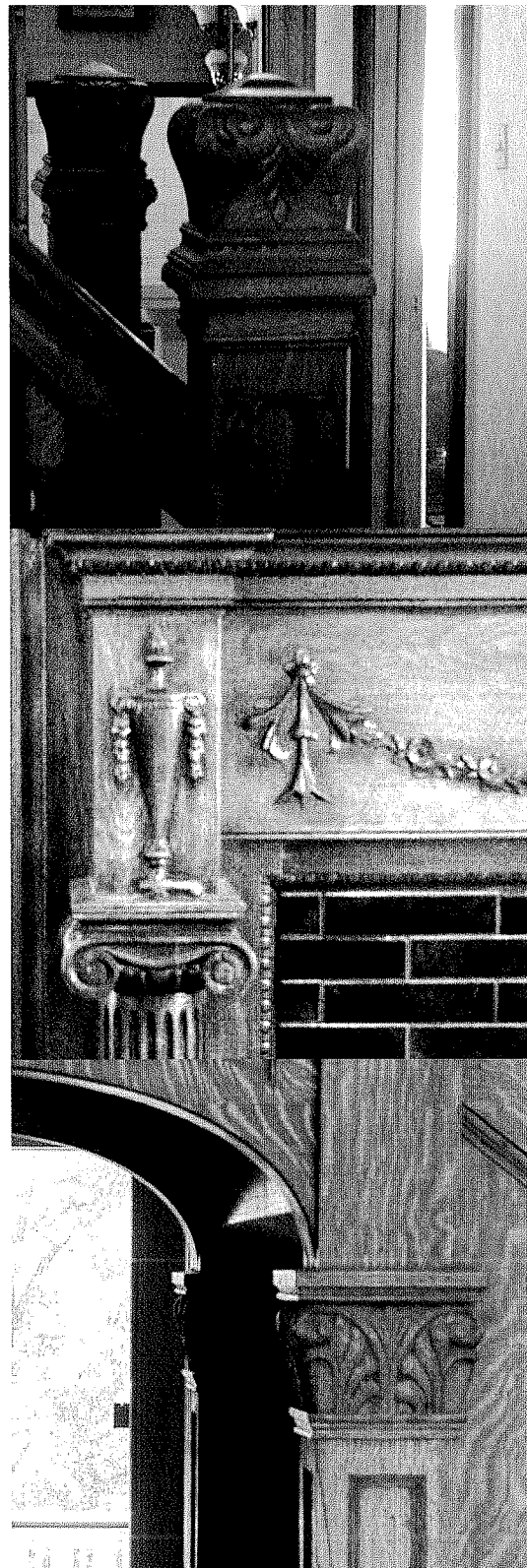

THE BRICKS IN DETAIL

- Bricks measure 4" by 8"
- Each brick can be imprinted with up to three lines although two are recommended.
- A maximum of 14 characters per line, including punctuation and spaces, is available on each brick.
- Location of bricks will be by chance within a specified area.

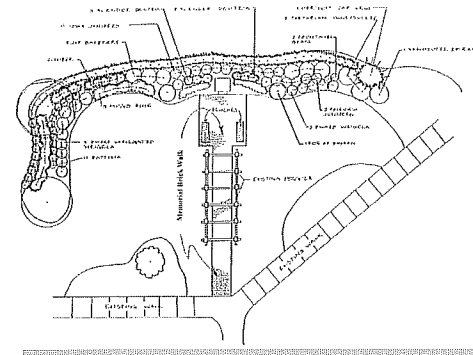

TURNER-DODGE HOUSE

100 E. North Street
Lansing, Michigan 48906
Phone 517/483-4220
Fax 527/483-6081

Design and photography by Brian J. Bohnett

THE TURNER-DODGE HOUSE

HISTORIC PRESERVATION PROJECT

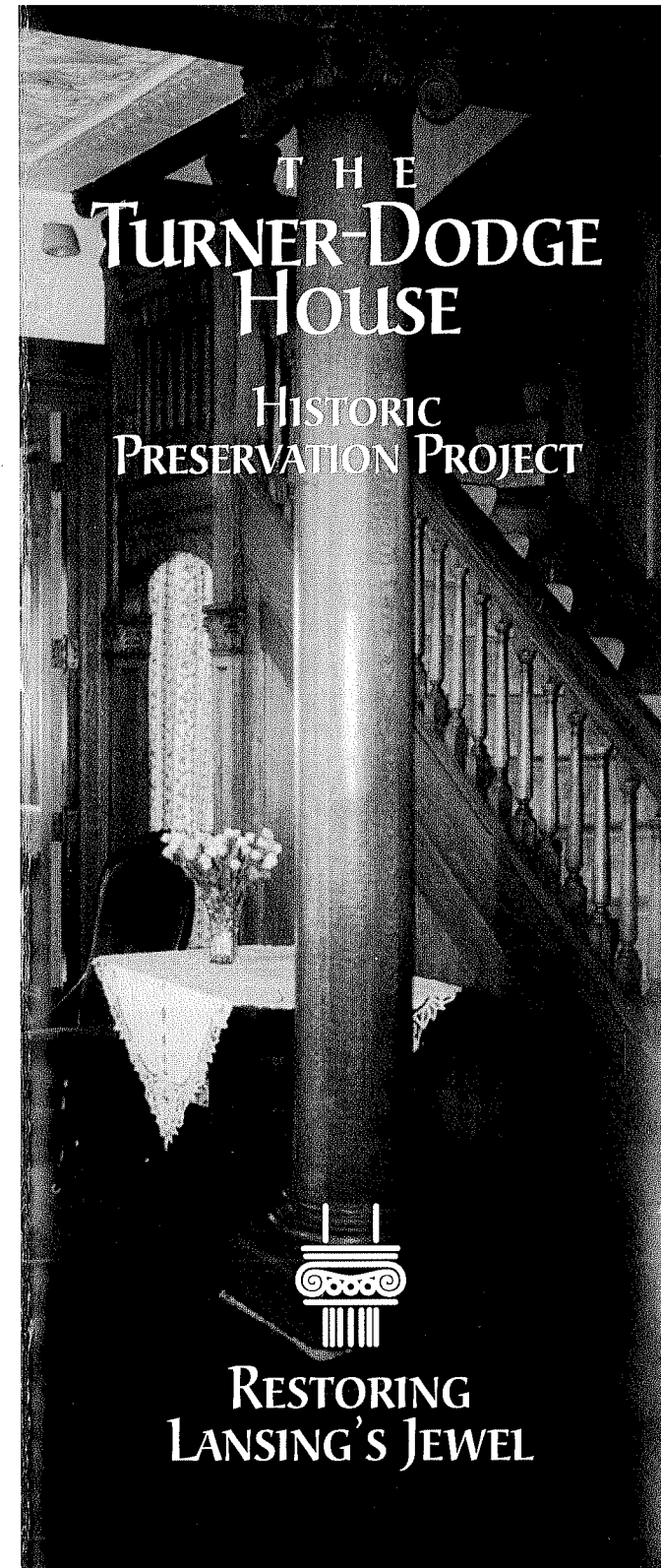

RESTORING LANSING'S JEWEL